



OB 8 HIGH DEFINITION PRODUCTION TRUCK

OB 8 is an HD capable, 13.5m single expanding, fully-integrated digital widescreen production unit with VT edit and slo-mo areas, all in one spacious state-of-the-art vehicle. OB 8 is equipped with up to 20 Sony HDC 1500 cameras, a Sony MVS 8000 vision mixer and a Calrec Sigma digital audio desk with Bluefin. It boasts an innovative use of space, with the capability for housing a wide range of VT requirements under one roof.

SPECIFICATIONS

VEHICLE

Length 13.5m
Height 4m
Width 3.5m (expanded) 2.5m closed

CAMERAS

20 Sony HDC 1500/3300 HD cameras
A full range of Canon lenses

AUDIO

Calrec Sigma digital audio desk with Bluefin
128 AES inputs
128 Analogue inputs
128 AES outputs
112 Analogue outputs
Probel 256 x 256 AES audio router
Reidel 88 x 88 Talkback system
4 Dolby e encoders
6 Dolby e decoders

VISION

Vision control with 5 Sony HD grade 1 monitors
Probel 256 x 256 multi format video router
12 HD/SDI external remote source inputs
6 HD Down converters
6 Cross converters
4 Synchronisers
4 SDI Aspect ratio converters
3 HD Hex splits

FLOOR PLAN

VISION

PRODUCTION

SOUND

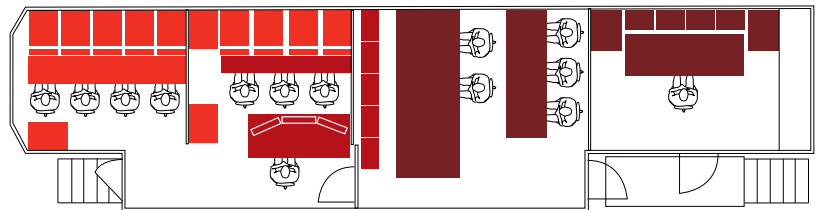

VT AND EDITING

Up to 14 recorders inc. 7 x 6 Channel HD EVS
Immediate access to all EVS clips on XHub when using Final Cut Pro in conjunction with our server systems
Other edits available on request

PRODUCTION

Production area with expanding side
15 x 23" Vutrix LCD HD quad split monitors giving a maximum total of 60 screens with built in UMDs
4 x 17" Vutrix HD quad split monitors giving a maximum total of 16 screens with built in UMDs on rear desk
Sony MVS 8000 4ME Vision Mixer with 54 inputs, 24 outputs and built in DME

POWER

3 phase 125 amp power input
60kw air-conditioning